



Body Size

1/4"

2482 bar

77-Series**Technical Description**

Parker Snap-tite 77 series is designed for working pressures up to 2482 bar. Available in steel and stainless steel.

Advantages

- Drybreak with minimal fluid loss
- Wide range of end fittings
- Dog-lock mechanism preventing ball brinnelling
- Internal sleeve-lock as safety feature

Applications

- Hydraulic test stands
- Hydrotesting
- Offshore drilling & Production

Working Pressure

See charts.

Working Temperature

- 35°C up to +120°C (NBR)
- 26°C up to +204°C (FKM)
- 56°C up to +120°C (EPR) depending on the medium.

77-Series is also available with FKM or EPR seal. Add the suffix **V** for FKM and the suffix **E** for EPR to the part number, e.g. **77C4-4FV**.

Material Coupling	Steel	Stainless Steel
Coupling Body	Steel	AISI 316 dual certified
Sleeve	Steel	AISI 316 dual certified
Back-up Ring	Delrin	Delrin
Valve	Steel	AISI 316 controlled strength
Springs	17-7	17-7
Dog Locks	Steel	AISI 316
Seals	NBR	NBR
Valve Holder	Steel	AISI 316 controlled strength
Material Plug	Steel	Stainless Steel
Plug Body	Steel	AISI 316 controlled strength
Valve	Steel	AISI 316 controlled strength
Springs	17-7	17-7
Seals	NBR	NBR
Valve Holder	Steel	AISI 316 controlled strength

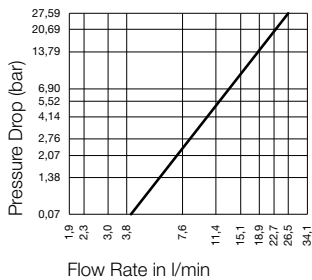
Flow Capacity with MIL-H-6083 Hydraulic Fluid at 32°C +/-1,5°C

Couplings

77-Series Steel

2482 bar

High Pressure

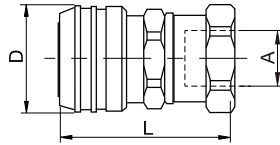

Female Thread

Body Size	Connection A	L mm	D mm	Weight kg	Max. Operating Pressure in bar	Part Number
1/4"	1/4-18 NPTF	80,82	36,58	0,55	689	77C4-4F
1/4"	9/16-18 UNF-2B	80,82	36,58	0,55	1379	77C4-SF375CX
1/4"	13/16-16 UNF-2B	83,36	36,58	0,55	1379	77C4-SF562CX
1/4"	9/16-18 UNF-2A	84,12	36,58	0,55	1379	77C4-SM375CX
1/4"	13/16-16 UNF-2A	87,17	36,58	0,55	1379	77C4-SM562CX
1/4"	9/16-18 UNF-2B	73,20	36,58	0,55	2482	77C4-F250C
1/4"	9/16-18 UNF-2A	79,30	36,58	0,55	2482	77C4-M250C
1/4"	3/4-16 UNF-2A	77,77	36,58	0,55	2482	77C4-RH12
1/4"	1 1/8"-12 UNF-2A	90,22	36,58	0,55	2482	77C4-M562C
1/4"	9/16-18 UNF-2A	74,47	36,58	0,55	2482	77C4-RH9
1/4"	1-12 UNF-2A	81,58	36,58	0,55	2482	77C4-RH16

Plugs

77-Series Steel

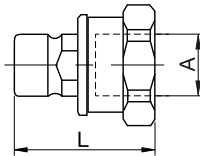

Female Thread

Body Size	Connection A	L mm	D mm	Weight kg	Max. Operating Pressure in bar	Part Number
1/4"	1/4-18 NPTF	63,20		0,20	689	77N4-4F
1/4"	9/16-18 UNF-2B	63,20		0,20	1379	77N4-SF375CX
1/4"	13/16-16 UNF-2B	65,74		0,20	1379	77N4-SF562CX
1/4"	9/16-18 UNF-2A	66,50		0,20	1379	77N4-SM375CX
1/4"	13/16-16 UNF-2A	69,55		0,20	1379	77N4-SM562CX
1/4"	9/16-18 UNF-2B	55,58		0,20	2482	77N4-F250C
1/4"	9/16-18 UNF-2A	61,68		0,20	2482	77N4-M250C
1/4"	3/4-16 UNF-2A	60,15		0,20	2482	77N4-RH12
1/4"	1 1/8"-12 UNF-2A	72,60		0,20	2482	77N4-M562C
1/4"	9/16-18 UNF-2A	56,85		0,20	2482	77N4-RH9
1/4"	1-12 UNF-2A	63,96		0,20	2482	77N4-RH16

Couplings

77-Series Stainless Steel

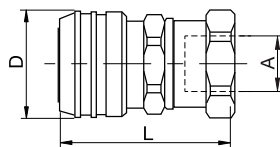

Female Thread

Body Size	Connection A	L mm	D mm	Weight kg	Max. Operating Pressure in bar	Part Number
1/4"	1/4-18 NPTF	80,82	36,58	0,55	689	S77C4-4F
1/4"	9/16-18 UNF-2B	80,82	36,58	0,55	1379	S77C4-SF375CX
1/4"	13/16-16 UNF-2B	83,36	36,58	0,55	1379	S77C4-SF562CX
1/4"	9/16-18 UNF-2A	84,12	36,58	0,55	1379	S77C4-SM375CX
1/4"	13/16-16 UNF-2A	87,17	36,58	0,55	1379	S77C4-SM562CX
1/4"	9/16-18 UNF-2B	73,20	36,58	0,55	1379	S77C4-F250C
1/4"	9/16-18 UNF-2A	79,30	36,58	0,55	1379	S77C4-M250C
1/4"	3/4-16 UNF-2A	77,77	36,58	0,55	1379	S77C4-RH12
1/4"	1 1/8"-12 UNF-2A	90,22	36,58	0,55	1379	S77C4-M562C
1/4"	9/16-18 UNF-2A	74,47	36,58	0,55	1379	S77C4-RH9
1/4"	1-12 UNF-2A	81,58	36,58	0,55	1379	S77C4-RH16

Plugs

77-Series Stainless Steel

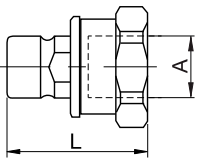
	Body Size	Connection A	L mm	D mm	Weight kg	Max. Operating Pressure in bar	Part Number
 <p>Female Thread</p>	1/4"	1/4-18 NPTF	63,20		0,20	689	S77N4-4F
	1/4"	9/16-18 UNF-2B	63,20		0,20	1379	S77N4-SF375CX
	1/4"	13/16-16 UNF-2B	65,74		0,20	1379	S77N4-SF562CX
	1/4"	9/16-18 UNF-2A	66,50		0,20	1379	S77N4-SM375CX
	1/4"	13/16-16 UNF-2A	69,55		0,20	1379	S77N4-SM562CX
	1/4"	9/16-18 UNF-2B	55,58		0,20	1379	S77N4-F250C
	1/4"	9/16-18 UNF-2A	61,68		0,20	1379	S77N4-M250C
	1/4"	3/4-16 UNF-2A	60,15		0,20	1379	S77N4-RH12
	1/4"	1 1/8"-12 UNF-2A	72,60		0,20	1379	S77N4-M562C
	1/4"	9/16-18 UNF-2A	56,85		0,20	1379	S77N4-RH9
	1/4"	1-12 UNF-2A	63,96		0,20	1379	S77N4-RH16

